

**Repair Kits**

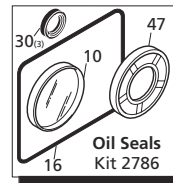
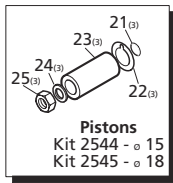
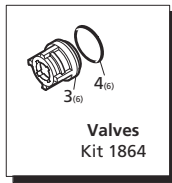

**Special Parts / Kits**

Code	Description	Qty
2776	Viton water seals ø15	1
2777	Viton water seals ø18	1
2817	Kit for up to 180°F ø15 High Temp	1
42212	Kit for up to 180°F ø15 High Temp	1
2729	Rail Kit - 5/8" - 2 Rails & 4 Bolts	1
2633	Rail Kit - 1-3/4" - 2 Rails & 4 Bolts	1
2633H	Rail Kit - 2-5/8" - 2 Rails & 4 Bolts	1

Pos	Code	Description	Qty	Pos	Code	Description	Qty
1	960160	O-Ring ø17.86x2.62	6	30	1260460	Oil seal	3
2	1269657	Valve cap	(442 in/lbs) 6	31	1780100	Rear piston guide	ø15 3
3	1260162T	Valve Cap 1/4" threaded	(442 in/lbs) 1	32	1780120	Rear piston guide	ø18 3
4	1269050	Complete valve	6	33	770260	O-Ring ø23.52x1.78	3
5	880830	O-Ring ø15.54x2.62	6	34	1260440	Low pressure seal	ø15 3
6	620301	Plug 1/8" G	1	35	1260450	Low pressure seal	ø18 3
7	1780130	Support ring	ø15 3	36	820361	Plug 1/2" G - Brass	1
8	1780140	Support ring	ø18 3	37	180101	O-Ring ø17.5x2	1
9	1260130	High pressure packing	ø15 3	38	1780020	Pump head	1
10	1260220	High pressure packing	ø18 3	39	1381550	Washer	8
11	1780090	Piston guide	ø15 3	40	1322730	Head bolt M6x60	(133 in/lbs) 8
12	1780110	Piston guide	ø18 3	41	1321190	Bearing	1
13	1780010	Pump body	1	42	1321080	Snap ring	1
14	1266740	Side cover seal	1	43	1780150	Crankshaft 24mm	○ 1
15	1260790	Circlip øi52	1	44	1780160	Crankshaft 24mm	■ 1
16	1780550	Snap ring	1	45	1780180	Crankshaft 24mm	△ 1
17	1780490	Bearing	1	46	1380520	Key	1
18	880130	Vented oil cap	1	47	1260750	Oil seal	1
19	1780050	Piston pin	3	57	1789201	Complete pump head	ø15 1
20	1780510	O-Ring	1	58	1789202	Complete pump head	ø18 1
21	1200430	Bolt M6x16	(89 in/lbs) 6	71	1260250	Oil sight glass	1
22	1789010	Complete cover	1	72	1260430	Snap ring	1
23	1780040	Con rod	3	73	1780690	Contrast disc	1
24	1780060	Guiding piston	3	74	1140450	O-Ring ø20.24x2.62	1
25	480480	O-Ring ø4.48x1.78	3		AR64516	Oil	1
26	1260091	Washer (slinger)	3			<i>OIL CAPACITY - 14.5 oz</i>	
27	1780070	Plunger	ø15 3				
28	1780080	Plunger	ø18 3				
29	1260100	Piston washer	3				
	1260110	Nut M8	(106 in/lbs) 3				
	1380141	Rail 5/8"	2				
	Z-Bracket 1-3/4"	Rail 1-3/4"	2				
	Z-Bracket	Rail 2-5/8"	2				
	740290	O-Ring ø14x1.78	3				
	1980740	Plug 3/8" G	3				
	1260470	Bolt M8x10	4				

**Legend**

ø 15	ø 18	ø 18
For ○	For △	For ■
XM11.17	XM13.17	XM15.15